

# Pin Power Inductor

## 1 Appearance and dimensions (mm)

外形尺寸

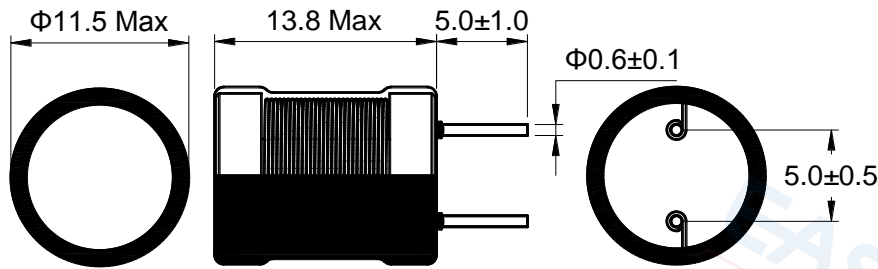

## 2 Reference land pattern (mm)

参考基板尺寸

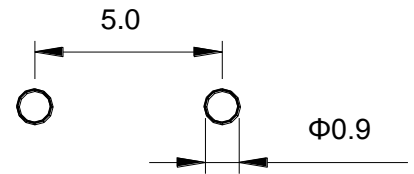

## 3 Electrical characteristics 电气特性

Part No. 型号	Inductance (μH) 电感值 ※1 ±10%	D.C.R. (mΩ) 直流电阻		Saturation current (A) 饱和电流 ※2		Temperature rise current (A) 温升电流 ※3
		Typical	Max	Typical	Max	Typical
DR2W0912-100K	10.0	17.7	21.2	4.80	3.84	5.60
DR2W0912-120K	12.0	19.1	22.9	4.70	3.76	5.37
DR2W0912-150K	15.0	22.4	26.9	4.40	3.52	4.96
DR2W0912-180K	18.0	25.3	30.4	4.10	3.28	4.73
DR2W0912-220K	22.0	28.2	33.8	3.20	2.56	4.43
DR2W0912-270K	27.0	32.3	38.8	3.10	2.48	4.13
DR2W0912-330K	33.0	41.1	49.3	2.80	2.24	3.66
DR2W0912-390K	39.0	45.2	54.3	2.70	2.16	3.49
DR2W0912-470K	47.0	57.7	69.3	2.35	1.88	3.05
DR2W0912-560K	56.0	63.7	76.4	2.10	1.68	2.97
DR2W0912-680K	68.0	71.4	85.7	2.00	1.60	2.78
DR2W0912-820K	82.0	91.4	110	1.90	1.52	2.36
DR2W0912-101K	100	105	125	1.65	1.32	2.21
DR2W0912-121K	120	139	167	1.55	1.24	1.94
DR2W0912-151K	150	162	195	1.45	1.16	1.84
DR2W0912-181K	180	183	220	1.32	1.06	1.73
DR2W0912-221K	220	231	278	1.15	0.92	1.54
DR2W0912-271K	270	262	315	1.08	0.86	1.45
DR2W0912-331K	330	333	399	0.97	0.78	1.27
DR2W0912-391K	390	408	490	0.88	0.70	1.13
DR2W0912-471K	470	477	572	0.82	0.66	1.08
DR2W0912-561K	560	578	694	0.74	0.59	0.96
DR2W0912-681K	680	722	866	0.61	0.49	0.87
DR2W0912-821K	820	810	972	0.56	0.45	0.83
DR2W0912-102K	1,000	1,093	1,312	0.48	0.38	0.69

All data is tested based on 25 °C ambient temperature. 所有测试数据基于环境温度25 °C条件下测试。

※1. Inductance measure condition at 1kHz, 0.25V. 电感测试条件为1kHz, 0.25V.

※2. Saturation current the actual value of DC current when the inductance decrease 20% of its initial value.  
饱和电流：电感值下降其初始值的20%时所加载的实际直流电流值。

※3. Temperature rise current the actual value of DC current when the temperature rise is ΔT40 (Ta=25 ).  
温升电流：使产品温度上升到ΔT40 °C时所加载的实际直流电流值(Ta=25 °C)